



# Tecumseh

Kompressor  
Spannungscode : FZ

## AE2430Z-FZ3C

Gewerbliche Kühlung (Tiefk.) (BP)

220 - 240V 1~ 50 Hz

R452A / R404A / R448A / R449A

## AE2430Z-FZ3C

| Bedingungen     | Frequenz | Nennkälteleistung |       | Schalleistung<br>ISO3745 / ISO 3743-1 |
|-----------------|----------|-------------------|-------|---------------------------------------|
|                 |          | Watts             | BTU/h |                                       |
| EN12900 / R452A | 50 Hz    | 384               | 1308  | 57 dBA                                |
| EN12900 / R404A | 50 Hz    | 419               | 1429  | 57 dBA                                |
| EN12900 / R448A | 50 Hz    | 326               | 1112  | 57 dBA                                |
| EN12900 / R449A | 50 Hz    | 326               | 1112  | 57 dBA                                |

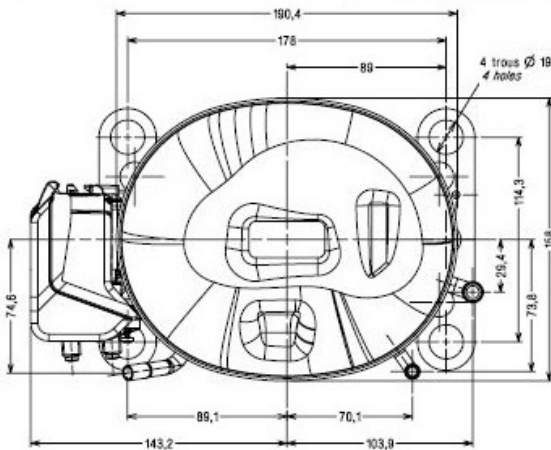
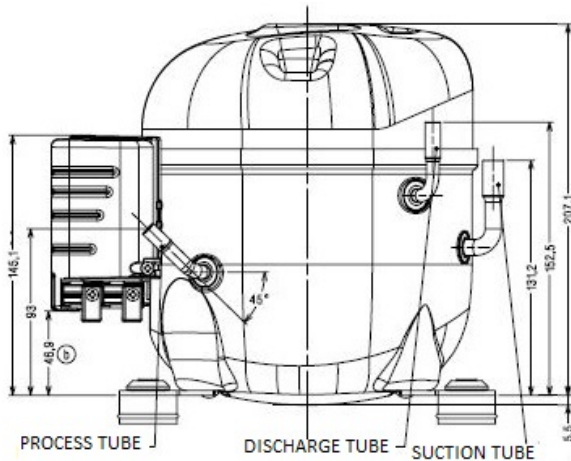

\* EN12900 : T°Verf. 40.0°C / T°Verdampf.. -35.0°C / T°Sauggastemp.. 20.0°C  
T°Unter Kühlung. 0.0K

Zulassungen :

|                                    |                                 |
|------------------------------------|---------------------------------|
| <b>Hubvolumen (cm<sup>3</sup>)</b> | 14,51                           |
| <b>Nettogewicht (kg)</b>           | 11,5                            |
| <b>Ölmenge (cm<sup>3</sup>)</b>    | 380,0                           |
| <b>Ölsorte</b>                     | P.O.E                           |
| <b>Expansion</b>                   | Capillary_Tube or Expansion_Val |
| <b>Kühlung</b>                     | Belüftet                        |
| <b>Hauptphase (Ohm)</b>            | 3,37                            |
| <b>Hilfsphase (Ohm)</b>            | 11,99                           |
| <b>Strom</b>                       |                                 |
| Nennstrom (A)                      | 3,5                             |
| Maximalstrom (A)                   | 5,1                             |
| Anlaufstrom (A)                    | 21,5                            |
| <b>Typ Schaltanlage</b>            | CSR                             |
| <b>Schutz</b>                      | MSP36AMW                        |
| Verzögerung                        | 6,5s - 16s / 12,4 A             |
| Öffnungs-Temp.                     | 135°C                           |
| Schließ-Temp.                      | 61°C                            |
| <b>Anlaufkondensator</b>           | 88-108 µf / 330 V               |
| <b>Betriebskondensator</b>         | 10 µF / 400 V                   |
| <b>Potenzialrelais</b>             | RVA60**                         |
| Einschaltung                       | 277/305V                        |
| Ausschaltung                       | 60/135V                         |
| <b>Außendurchmesser</b>            |                                 |
| Ø Saugleitung                      | 9,5 (3/8")                      |
| Ø Druckleitung                     | 6,35 (1/4")                     |
| Ø Prozessleitung                   | 6,35 (1/4")                     |

NB: Tecumseh behält sich das Recht vor, die in diesem Dokument enthaltenen Informationen ohne vorherige Ankündigung zu verändern



**Tecumseh**

|                     |   |
|---------------------|---|
| <b>AE2430Z-FZ3C</b> | <b>Tension FZ : 220 - 240V 1~ 50 Hz</b> |
|---------------------|---|

|  |                        |         |
|--|------------------------|---------|
| Les performances sont données dans les <b>conditions EN12900</b> : | Gaz aspirés :          | 20.0 °C |
| Condition Dew  | Sous refroidissement : | 0.0 K   |
| The performance data are in <b>EN12900 conditions</b> :            | Return gas :           | 20.0 °C |
| Dew Condition  | Subcooling :           | 0.0 K   |

| <b>50 Hz R452A</b> |                    |        |            |            |            |            |            |            |            |
|--------------------|--------------------|--------|------------|------------|------------|------------|------------|------------|------------|
| <b>N°3476</b>      |                    |        |            |            |            |            |            |            |            |
| 4   T condensation | 5   T évaporation  | (°C)   | <b>-40</b> | <b>-35</b> | <b>-30</b> | <b>-25</b> | <b>-20</b> | <b>-15</b> | <b>-10</b> |
| <b>30</b>          | 1   P frigorifique | (Watt) | 330        | 460        | 611        | 786        | 992        | 1232       | 1513       |
|                    | 2   P absorbée     | (W)    | 324        | 371        | 424        | 481        | 541        | 601        | 659        |
|                    | 3   I absorbée     | (A)    | 2.03       | 2.19       | 2.38       | 2.60       | 2.83       | 3.08       | 3.34       |
| <b>40</b>          | 1   P frigorifique | (Watt) | 270        | 384        | 512        | 662        | 836        | 1042       | 1283       |
|                    | 2   P absorbée     | (W)    | 336        | 384        | 437        | 495        | 555        | 615        | 674        |
|                    | 3   I absorbée     | (A)    | 2.09       | 2.25       | 2.45       | 2.67       | 2.91       | 3.17       | 3.43       |
| <b>50</b>          | 1   P frigorifique | (Watt) |            | 306        | 415        | 541        | 687        | 860        | 1064       |
|                    | 2   P absorbée     | (W)    |            | 396        | 453        | 513        | 576        | 639        | 700        |
|                    | 3   I absorbée     | (A)    |            | 2.29       | 2.50       | 2.73       | 2.99       | 3.26       | 3.54       |
| <b>60</b>          | 1   P frigorifique | (Watt) |            |            |            | 415        | 536        | 678        | 846        |
|                    | 2   P absorbée     | (W)    |            |            |            | 525        | 593        | 661        | 728        |
|                    | 3   I absorbée     | (A)    |            |            |            | 2.79       | 3.06       | 3.35       | 3.66       |

| <b>50 Hz R404A</b> |                    |        |            |            |            |            |            |            |            |
|--------------------|--------------------|--------|------------|------------|------------|------------|------------|------------|------------|
| <b>N°3310</b>      |                    |        |            |            |            |            |            |            |            |
| 4   T condensation | 5   T évaporation  | (°C)   | <b>-40</b> | <b>-35</b> | <b>-30</b> | <b>-25</b> | <b>-20</b> | <b>-15</b> | <b>-10</b> |
| <b>30</b>          | 1   P frigorifique | (Watt) | 367        | 506        | 662        | 840        | 1048       | 1289       | 1569       |
|                    | 2   P absorbée     | (W)    | 353        | 398        | 449        | 506        | 568        | 634        | 705        |
|                    | 3   I absorbée     | (A)    | 2.20       | 2.35       | 2.52       | 2.73       | 2.97       | 3.25       | 3.57       |
| <b>40</b>          | 1   P frigorifique | (Watt) | 302        | 419        | 551        | 703        | 878        | 1083       | 1321       |
|                    | 2   P absorbée     | (W)    | 363        | 412        | 467        | 527        | 592        | 662        | 736        |
|                    | 3   I absorbée     | (A)    | 2.26       | 2.42       | 2.62       | 2.84       | 3.11       | 3.41       | 3.75       |
| <b>50</b>          | 1   P frigorifique | (Watt) |            | 334        | 444        | 571        | 717        | 887        | 1085       |
|                    | 2   P absorbée     | (W)    |            | 424        | 485        | 552        | 625        | 701        | 782        |
|                    | 3   I absorbée     | (A)    |            | 2.45       | 2.68       | 2.94       | 3.24       | 3.57       | 3.95       |
| <b>60</b>          | 1   P frigorifique | (Watt) |            |            | 336        | 437        | 554        | 690        | 847        |
|                    | 2   P absorbée     | (W)    |            |            | 494        | 571        | 653        | 739        | 829        |
|                    | 3   I absorbée     | (A)    |            |            | 2.72       | 3.02       | 3.37       | 3.75       | 4.17       |

1 = cooling capacity 2 = power input 3 = current 4 = condensing temperature 5 = evaporating temperature

**Nota : Tecumseh se réserve le droit de modifier les informations contenues dans ce document sans préavis.**  
**Note : Tecumseh reserves the right to change information contained in this document without notification.**

© 2024 Tecumseh Products Company  
All rights reserved



**Tecumseh**

|                     |   |
|---------------------|---|
| <b>AE2430Z-FZ3C</b> | <b>Tension FZ : 220 - 240V 1~ 50 Hz</b> |
|---------------------|---|

Les performances sont données dans les **conditions EN12900** :  
 Condition Dew  
 The performance data are in **EN12900 conditions** :  
 Dew Condition

Gaz aspirés : 20.0 °C  
 Sous refroidissement : 0.0 K  
 Return gas : 20.0 °C  
 Subcooling : 0.0 K

© 2024 Tecumseh Products Company  
All rights reserved

**50 Hz R448A (\*)**

**N°3477**

| 4   T condensation | 5   T évaporation  | (°C)   | <b>-35</b> | <b>-30</b> | <b>-25</b> | <b>-20</b> | <b>-15</b> | <b>-10</b> |
|--------------------|--------------------|--------|------------|------------|------------|------------|------------|------------|
| <b>30</b>          | 1   P frigorifique | (Watt) | 393        | 541        | 715        | 921        | 1164       | 1450       |
|                    | 2   P absorbée     | (W)    | 343        | 392        | 445        | 503        | 567        | 636        |
|                    | 3   I absorbée     | (A)    | 2.03       | 2.20       | 2.40       | 2.64       | 2.91       | 3.22       |
| <b>40</b>          | 1   P frigorifique | (Watt) | 326        | 453        | 603        | 781        | 991        | 1240       |
|                    | 2   P absorbée     | (W)    | 357        | 409        | 466        | 526        | 592        | 661        |
|                    | 3   I absorbée     | (A)    | 2.10       | 2.29       | 2.51       | 2.76       | 3.05       | 3.37       |
| <b>50</b>          | 1   P frigorifique | (Watt) | 263        | 373        | 502        | 654        | 836        | 1051       |
|                    | 2   P absorbée     | (W)    | 367        | 427        | 490        | 558        | 629        | 703        |
|                    | 3   I absorbée     | (A)    | 2.12       | 2.35       | 2.61       | 2.89       | 3.20       | 3.56       |
| <b>60</b>          | 1   P frigorifique | (Watt) |            |            | 409        | 540        | 696        | 882        |
|                    | 2   P absorbée     | (W)    |            |            | 506        | 584        | 665        | 749        |
|                    | 3   I absorbée     | (A)    |            |            | 2.68       | 3.01       | 3.37       | 3.77       |

**50 Hz R449A (\*)**

**N°3478**

| 4   T condensation | 5   T évaporation  | (°C)   | <b>-35</b> | <b>-30</b> | <b>-25</b> | <b>-20</b> | <b>-15</b> | <b>-10</b> |
|--------------------|--------------------|--------|------------|------------|------------|------------|------------|------------|
| <b>30</b>          | 1   P frigorifique | (Watt) | 393        | 541        | 715        | 921        | 1164       | 1450       |
|                    | 2   P absorbée     | (W)    | 343        | 392        | 445        | 503        | 567        | 636        |
|                    | 3   I absorbée     | (A)    | 2.03       | 2.20       | 2.40       | 2.64       | 2.91       | 3.22       |
| <b>40</b>          | 1   P frigorifique | (Watt) | 326        | 453        | 603        | 781        | 991        | 1240       |
|                    | 2   P absorbée     | (W)    | 357        | 409        | 466        | 526        | 592        | 661        |
|                    | 3   I absorbée     | (A)    | 2.10       | 2.29       | 2.51       | 2.76       | 3.05       | 3.37       |
| <b>50</b>          | 1   P frigorifique | (Watt) | 263        | 373        | 502        | 654        | 836        | 1051       |
|                    | 2   P absorbée     | (W)    | 367        | 427        | 490        | 558        | 629        | 703        |
|                    | 3   I absorbée     | (A)    | 2.12       | 2.35       | 2.61       | 2.89       | 3.20       | 3.56       |
| <b>60</b>          | 1   P frigorifique | (Watt) |            |            | 409        | 540        | 696        | 882        |
|                    | 2   P absorbée     | (W)    |            |            | 506        | 584        | 665        | 749        |
|                    | 3   I absorbée     | (A)    |            |            | 2.68       | 3.01       | 3.37       | 3.77       |

1 = cooling capacity 2 = power input 3 = current 4 = condensing temperature 5 = evaporating temperature

(\*) Veuillez vous référer strictement aux Recommandations d'Utilisation et Bulletins Marketing Tecumseh du fait de la température de reflux élevée pour les applications LBP.

(\*) Due to very high discharge temperature especially on LBP conditions, please strictly refer to Tecumseh Guidelines & Marketing Bulletin when using this refrigerant.

**Nota : Tecumseh se réserve le droit de modifier les informations contenues dans ce document sans préavis.**

**Note : Tecumseh reserves the right to change information contained in this document without notification.**